

### Material Specification

**Housing:** ATSM A536, GRADE 65 -45-12, QT4510. Ductile Iron

**Gasket:** EPDM Code E

**Bolts/Nuts:** Carbon Steel Zinc Electroplated ISO 898-2:1992 \ GB/T3098.2-2000 Class 8.

**Pipe Material:** ASME B36.10、ASTM A53-A53M、ISO 4200、GB/T 21835

### Sizes Available:

1" - 12"

### Surface Treatment:

Ptd = Painted.

Gal = Hot-Dip Galvanised

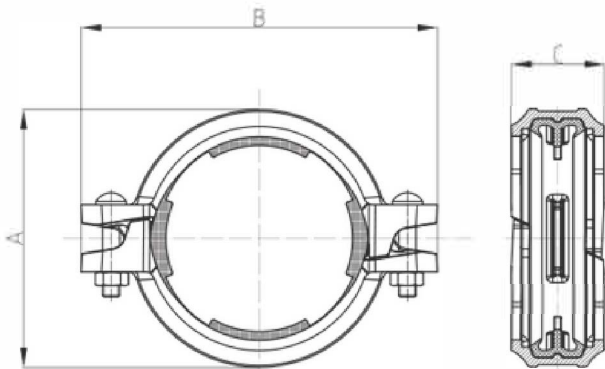

### Description

The Quick Fit Rigid Couplings are used for grooved pipeline connections. The Quick Fit Rigid Coupling comes assembled and is installed by placing it over the grooved end of a pipe, joined by a second grooved pipe and tightening the nuts and bolts. The Quick Fit Rigid Coupling is suitable for medium and low pressure pipeline systems such as water supply and drainage, fire protection, air conditioning, with a nominal pressure of less than 300PSI.

FQ CODE Ptd/Gal	Nominal Size mm/in	Pipe O.D mm/in	Working Pressure	Dimensions			Bolt Size
				A mm/in	B mm/in	C mm/in	No. Size mm
RGCP50	50	60.3	300	85	125.8	48	2-M10x57
RGCG50	2	2.375	2.07	3.35	4.95	1.89	
RGCP65	65	76.1	300	100	140	48	2-M10x57
RGCG65	2½	3.000	2.07	3.94	5.51	1.89	
RGCP80	80	88.9	300	112.3	160	48	2-M10x63
RGCG80	3	3.500	2.07	4.42	6.3	1.89	
RGCP100	100	114.3	300	137.50	196	50.5	2-M12x70
RGCG100	4	4.500	2.07	5.41	7.72	1.99	
RGCP150	150	165.1	300	189.6	249	52.5	2-M12x82
RGCG150	6	6.500	2.07	7.46	9.8	2.07	
RGCP200	200	216.3	300	244.80	322	60.5	2-M16x89
RGCG200	8	8.516	2.07	9.64	12.68	2.48	

\*Please call 02 9638 1300 if you require any other sizes not shown above.